

Sandstone Homeowners Association, Inc.

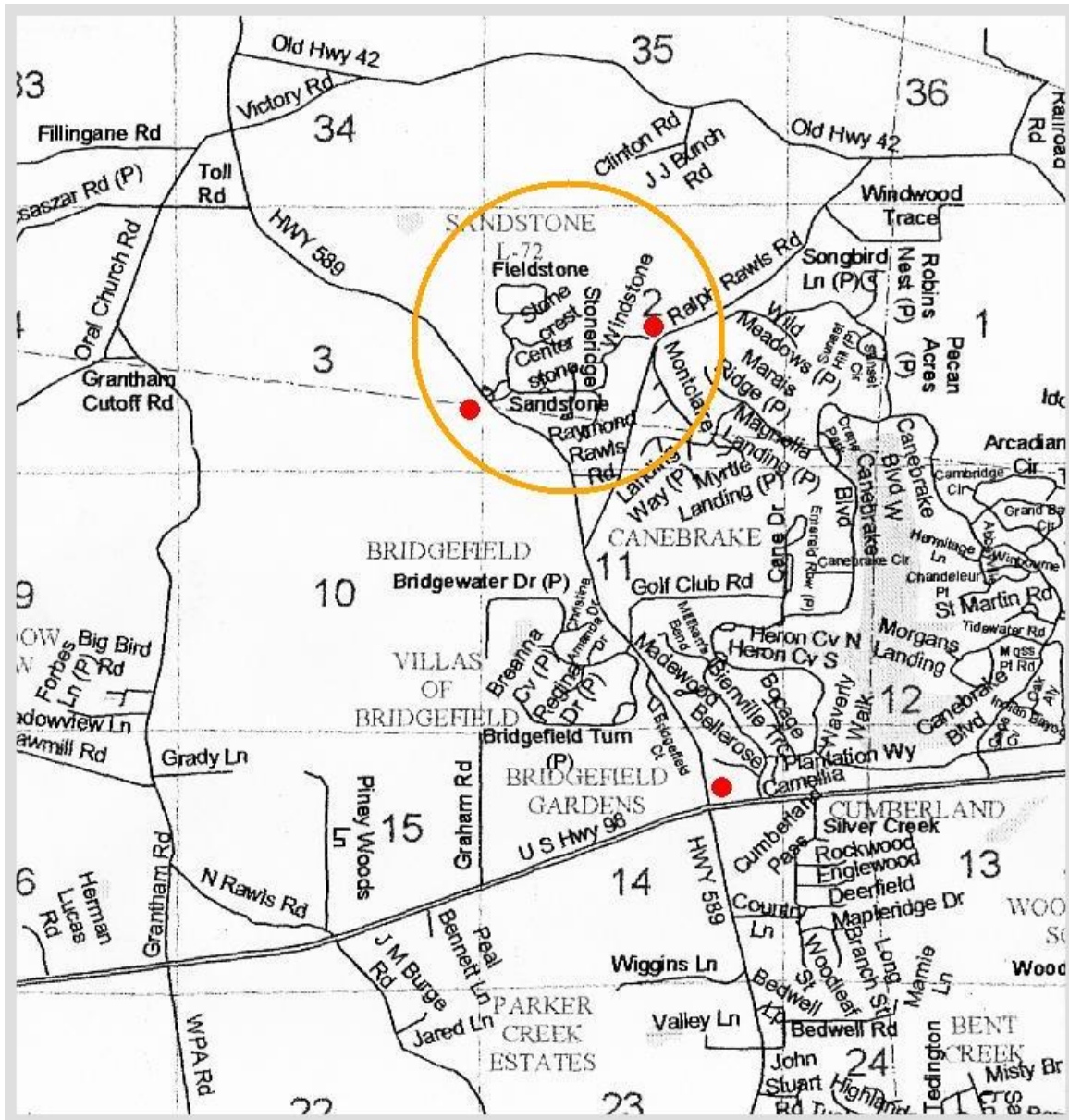

Sandstone is located approximately 10 miles west of Hattiesburg (from The University of Southern Mississippi), or about 8 miles west of the US-98/I-59 junction.

- Travel west on US-98 from Hattiesburg. At the US-589/US-98 intersection take the yield to the right, going north on US-589 to Sumrall.
- The main entrance to Sandstone is approximately 1-1/2 miles north on US-589. You will pass the side entrance to Canebrake on your right and the entrance to Bridgefield Estates on your left. The entrance comes up around a curve in the road, about 1/2 mile beyond Ralph Rawls Road.
- It is also convenient to enter Sandstone from the back entrance. Make the right onto Ralph Rawls Road as you come up US-589, then go along Ralph Rawls (past the stop sign) until you see a road on your left marked, 'Private Drive'. Turn left up this road to enter Sandstone.

Some additional details to enable you to find your way to Sandstone:

- You will be coming up on the intersection of US-589 and US-98 after passing Canebrake on the left on US-98 going west.
- At the intersection of US-589 and US-98 there is a Pure Service Station (it has a blue steel roof), and there is a traffic light. Take the yield to the right and this will put you on US-589 going north toward Sumrall.
- If you are coming in the front entrance to Sandstone, the entrance is 1.5 miles along US-589, after having made the right turn at the Pure Service Station.
- If you are coming in the front entrance to Sandstone from US-589, please note that the first stop sign is at Sandstone (the street). If you examine the map closely, you will note that the road makes a sharp bend near this entrance, so that if you are interested in coming to visit you either turn left at this point, or turn right, however the right turn will appear to you as a straight ahead road.
- If you are coming in the back entrance to Sandstone, the distance from US-589 and US-98 junction to Ralph Rawls Road is 1.1 miles.
- The distance along Ralph Rawls Road to the left turn going up the 'Private Drive' that leads to the back entrance of Sandstone is 0.8 miles. Be careful as there is a private driveway that is marked the same way about 30 yards up the road.

If you miss the turn-offs for either the front or rear entrance to Sandstone, you can backtrack by turning around at Old Highway 42. If you are coming in the back entrance and you come across a t-junction, it is Old Highway 42 and you have come too far. Go back to find the entrance to Sandstone on your right.